

# S-SERIES 200 INSTALLATION GUIDE

synesso

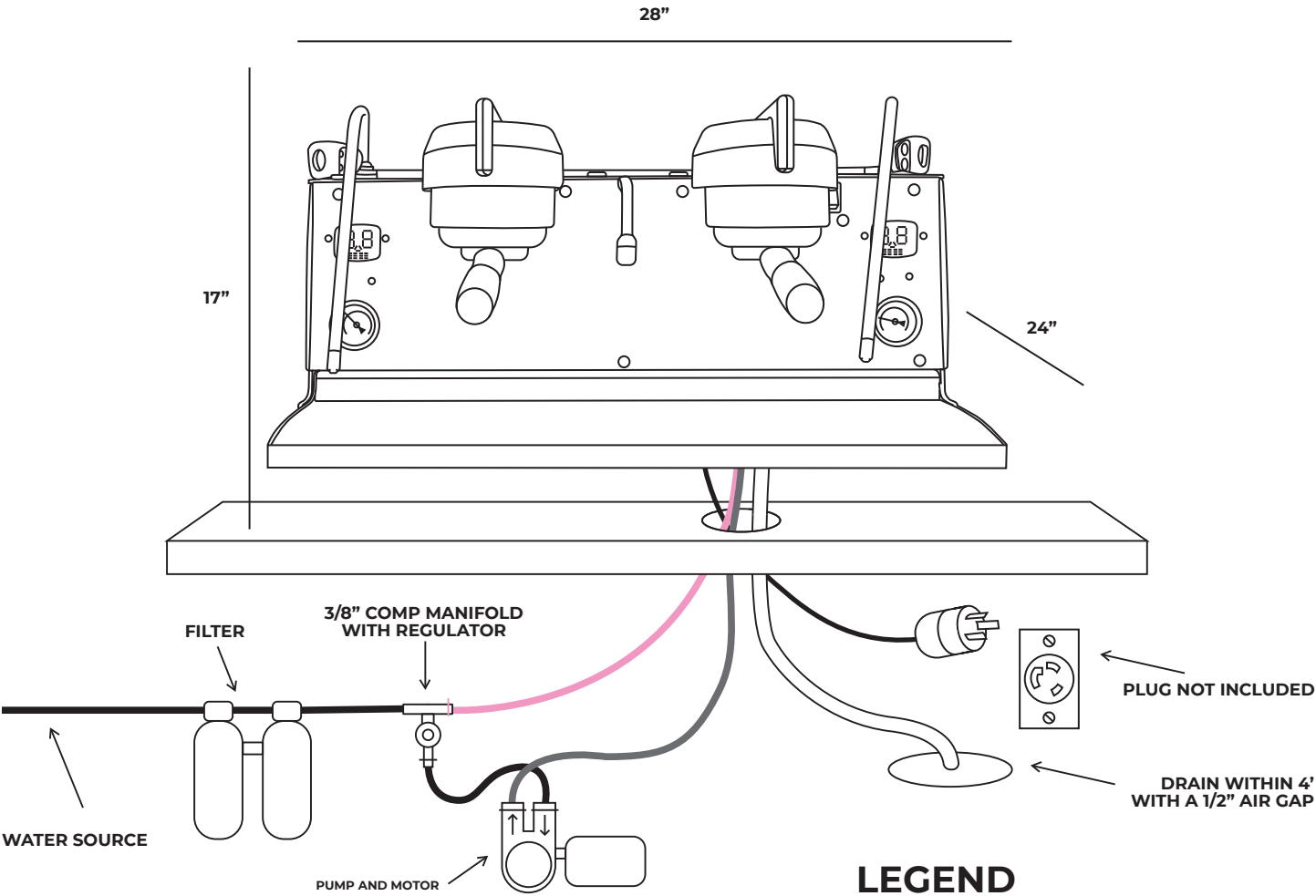

LINE PRESSURE  
MIN 50 PSI

COMPONENTS NOT TO SCALE

## TOP VIEW

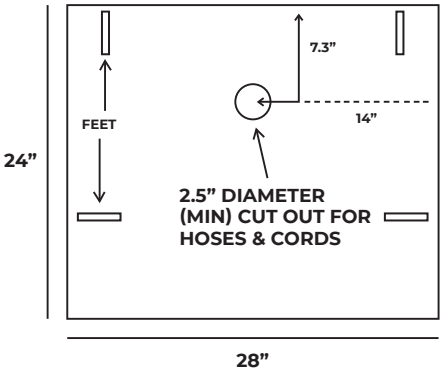

## LEGEND

PINK	STEAM
GREY	GROUPHEAD
BLACK	REGULATED TO PUMP INLET

## SPECIFICATIONS

- DIMENSIONS :** 17"(H) 28"(W) 24"(D)
- WEIGHT :** 152 LBS / 69 KGS
- ELECTRICAL :** VOLTS: 220 / AMPS: 28
- PLUMBING :** LINE PRESSURE OF 50PSI (MINIMUM)
- FITTING :** 3/8" MPT W/SHUT-OFF
- DRAINAGE :** WITHIN 4 FEET OF MACHINE

FOR COMPLETE INSTALL INSTRUCTIONS, PLEASE  
REFER TO TECHNICAL MANUAL PAGES 8-15